

## 411086. BUFFER EVA / PE / PVC

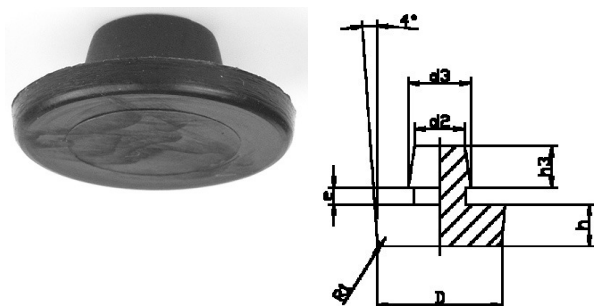

Artikelcode	d2	d3	D	h	h3	e	Materiaal
411086.030080205.000	2,5	3,5	8,0	2,5	5,0	2,0	EVA
411086.030100205.000	2,5	3,5	10,0	2,5	5,0	2,0	EVA
411086.040080205.000	3,0	4,5	8,0	2,5	5,0	2,0	EVA
411086.050080205.000	5,0	6,5	8,0	2,5	5,0	2,0	EVA
411086.055130200.000	5,0	6,0	13,0	5,2	5,0	2,0	PE
411086.060100205.000	5,0	6,5	10,0	2,5	5,0	2,0	EVA
411086.060100206.000	5,0	6,5	10,0	2,5	5,0	2,0	PE
411086.060120210.000	5,8	6,5	12,0	4,6		2,1	PVC
411086.060150150.000	4,0	6,0	15,0	5,0	5,0	1,5	PVC
411086.060150200.000	5,0	6,5	15,0	5,0	5,0	2,0	EVA
411086.060150206.000	5,0	6,5	15,0	5,0	5,0	2,0	PE
411086.067106070.000	6,5	7,5	10,6	8,1	3,9	2,0	PVC
411086.070100200.000	6,0	7,3	10,0	5,0	5,0	2,0	EVA
411086.070100200.004	6,0	7,3	10,0	5,0	5,0	2,0	EVA
411086.070100205.000	6,0	7,3	10,0	2,5	5,0	2,0	EVA
411086.070100206.000	6,0	7,3	10,0	5,0	5,0	2,0	PE
411086.070100207.000	6,0	7,3	10,0	2,5	5,0	2,0	PE
411086.070150200.000	6,0	7,3	15,0	5,0	5,0	2,0	EVA
411086.070150205.000	6,0	7,3	15,0	2,5	5,0	2,0	EVA
411086.070150206.000	6,0	7,3	15,0	5,0	5,0	2,0	PE
411086.070150207.000	6,0	7,3	15,0	2,5	5,0	2,0	PE
411086.070150210.000	6,0	7,3	15,0	3,5	5,0	2,0	EVA
411086.070150210.906	6,0	7,3	15,0	3,5	5,0	2,0	EVA
411086.070200200.000	6,0	7,3	20,0	5,0	5,0	2,0	EVA
411086.070200206.000	6,0	7,3	20,0	5,0	5,0	2,0	PE

Artikelcode	d2	d3	D	h	h3	e	Materiaal
411086.070220200.000	6,0	7,3	22,0	5,0	5,0	2,0	EVA
411086.070220206.000	6,0	7,3	22,0	5,0	5,0	2,0	PE
411086.070250200.000	6,0	7,3	25,0	5,0	5,0	2,0	EVA
411086.070250206.000	6,0	7,3	22,0	5,0	5,0	2,0	PE
411086.080130159.000	7,5	8,5	13,0	4,0	5,0	2,0	PAGV
411086.080130200.000	8,5	9,5	13,1	4,5	5,0	2,0	PE
411086.080150200.000	7,0	8,5	15,0	5,0	5,0	2,0	EVA
411086.080150206.000	7,0	8,5	15,0	5,0	5,0	2,0	PE
411086.080200200.000	7,0	8,5	20,0	5,0	5,0	2,0	EVA
411086.080200206.000	7,0	8,5	20,0	5,0	5,0	2,0	PE
411086.080220200.000	7,0	8,5	22,0	5,0	5,0	2,0	EVA
411086.080220205.000	7,0	8,5	22,0	2,5	5,0	2,0	EVA
411086.080220206.000	7,0	8,5	22,0	5,0	5,0	2,0	PE
411086.080220207.000	7,0	8,5	22,0	2,5	5,0	2,0	PE
411086.080250200.000	7,0	8,5	25,0	5,0	5,0	2,0	EVA
411086.080250206.000	7,0	8,5	22,0	5,0	5,0	2,0	PE
411086.090220200.000	8,0	9,0	22,0	5,0	5,0	2,0	EVA
411086.090250200.000	8,0	9,0	25,0	5,0	5,0	2,0	EVA
411086.100150200.000	9,0	10,5	15,0	5,0	5,0	2,0	EVA
411086.100150206.000	9,0	10,5	15,0	5,0	5,0	2,0	PE
411086.100200200.000	9,0	10,5	20,0	5,0	5,0	2,0	EVA
411086.100200206.000	9,0	10,5	20,0	5,0	5,0	2,0	PE
411086.100220200.000	9,0	10,5	22,0	5,0	5,0	2,0	EVA
411086.100220206.000	9,0	10,5	22,0	5,0	5,0	2,0	PE
411086.100250200.000	9,0	10,5	25,0	5,0	5,0	2,0	EVA
411086.100250206.000	9,0	10,5	25,0	5,0	5,0	2,0	PE
411086.110150200.000	10,0	12,0	15,0	5,0	5,0	2,0	EVA
411086.110150205.000	10,0	12,0	15,0	2,5	5,0	2,0	EVA
411086.110150206.000	10,0	12,0	15,0	5,0	5,0	2,0	PE
411086.110150207.000	10,0	12,0	15,0	2,5	5,0	2,0	PE
411086.110200200.000	10,0	12,0	20,0	5,0	5,0	2,0	EVA
411086.110200206.000	10,0	12,0	20,0	5,0	5,0	2,0	PE
411086.110220200.000	10,0	12,0	22,0	5,0	5,0	2,0	EVA
411086.110220200.001	10,0	12,0	22,0	5,0	5,0	2,0	EVA
411086.110220205.000	10,0	12,0	22,0	2,5	5,0	2,0	EVA
411086.110220206.000	10,0	12,0	22,0	5,0	5,0	2,0	PE
411086.110220207.000	10,0	12,0	22,0	2,5	5,0	2,0	PE
411086.110250200.000	10,0	12,0	25,0	5,0	5,0	2,0	EVA
411086.110250206.000	10,0	12,0	22,0	5,0	5,0	2,0	PE